

## Description:

Cartridge style counterbalance valve with internally vented spring chamber and a reverse flow check. Intended for use as a motion control and over-center load holding valve.

## Features:

- Common pilot ratios 2:1, 3:1, 4:1, 8:1, 10:1
- Sealed pilot piston for low leakage
- Quiet stable operation
- Low hysteresis
- Zinc plated exposed steel parts
- Anodized aluminum body for corrosion protection
- Standard setting is 3000 PSI  
*(Other settings can be specified, see model code on back.)*

## Flow Characteristics (32 CST / 150 SUS oil at 40C)

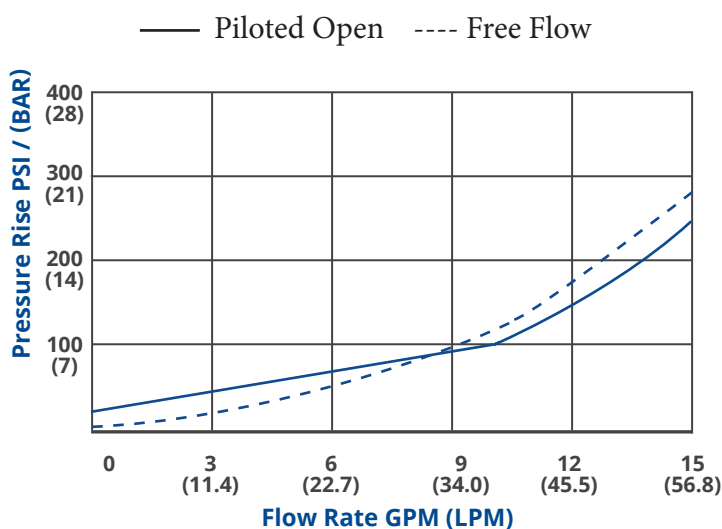

## Specifications:

Maximum pressure (Aluminum body)	3000 PSI (207 BAR)
Maximum setting	4000 PSI (345 BAR)
Maximum flow	15 GPM (57 LPM)
Port size	SAE -08
Body material	Aluminum
Filtration	ISO 4406
Fluids	Mineral based or synthetics 50-2000 SUS
Approx. Weight	2.7 Lbs.

The data and application materials contained herein are furnished for information only and believed to be reliable. Questions regarding specific applications or performance should be directed to JEM's application department. Since our products are being continuously improved, data contained herein is subject to change without notice. Warranty on FastLine products is 1 year from the date of sale.

**JEM Technical**  
 (888) 256-8266  
[www.jemtechnical.com](http://www.jemtechnical.com)



**JEM Technical Canada Ltd.**  
 (204) 654-1743  
[www.jemtechnical.ca](http://www.jemtechnical.ca)

## Installation Dimensions:

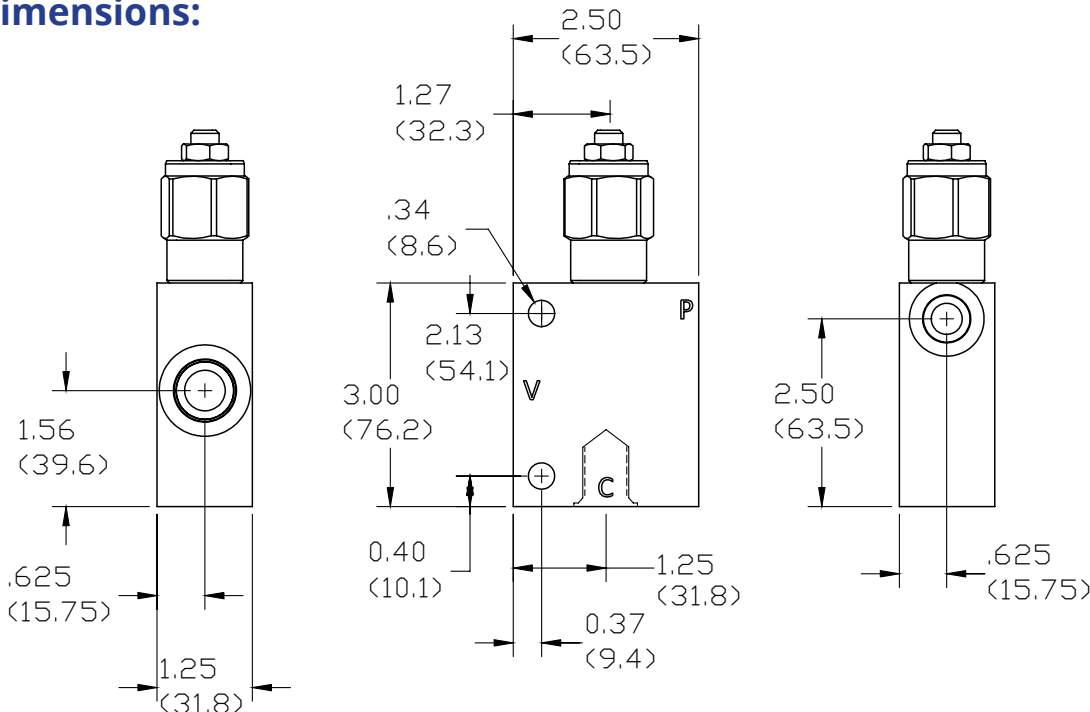

( ) Parentheses = Millimeters

## How To Order:



Example model code  
is the in-stock  
FastLine solution

## CBV20M A - 308T - \_ \_ - 3 30 - ST00

**Base Part No.**

**Adjustment Type:**  
A = Hex Allen Head  
F = Fixed setting

**Body Material:**  
Omit = Aluminum  
D = Ductile \*

**Seal Type:**  
Omit = Buna N  
V = Fluorocarbon \*\*

**3 Ports**  
Two SAE 08  
One SAE 06

**Pilot Ratio:**  
2 = 2:1  
3 = 3:1  
4 = 4:1  
8 = 8:1  
10 = 10:1

**Feature:**

ST00 = Standard  
ST0P = Standard, pilot seal  
GT0P = High flow, pilot seal  
R100 = Restrictive  
VST0 = Vented standard control  
VSTP = Vented with pilot seal

CBV Setting =  $\text{PSI} \div 100$

Std. adjustment range: 1000-4000 PSI

Not all Pilot ratios are available from stock. 3:1 & 4:1 ratios are the standard offering.

\*Ductile bodies have limited availability. Ductile bodies are recommended for working pressures over 3000 PSI.

\*\* Fluorocarbon seals are used when temperatures exceed 212° F (100° C).

## Typical Application

